



Standard Height Control

Visit our website for purchasing additional products, maintenance, warranty information, and to find the latest news from HOME Office Complete:

www.homeofficecomplete.com



Standard Height Control

Retrofittable Unit

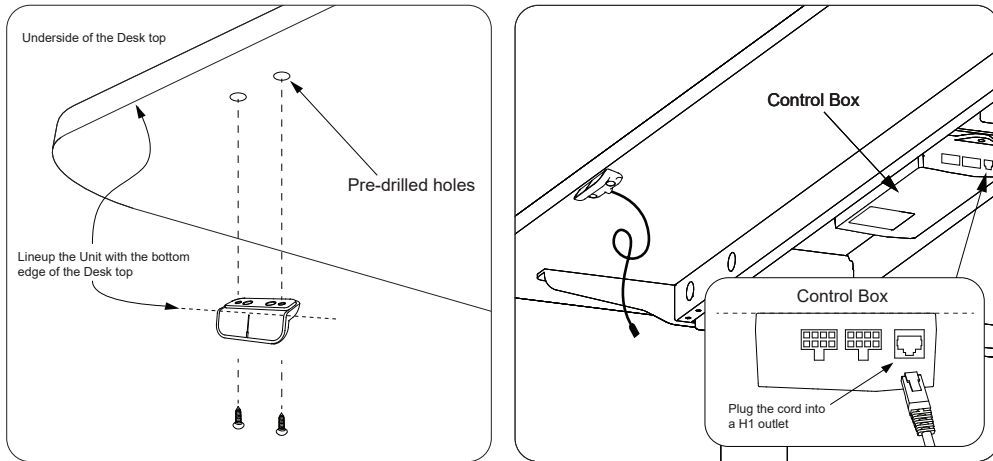
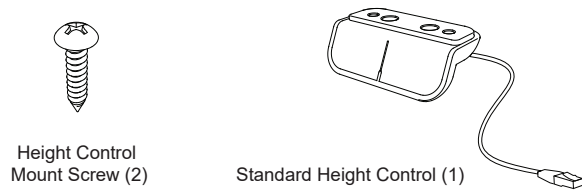

STEP 1 Install the Standard Height Control unit into the pre-drilled holes located on the underside of the Desktop. Before tightening the screws lineup the Unit with the bottom edge of the Desktop.

STEP 2 After installing the Standard Height Control unit connect it to the Control Box located on the underside of the Desktop between Desk construction beams. Plug the cord into the H1 outlet on the Control Box.

WARNING: To be installed on Desk Tops with a minimum thickness of 3/4"

1. Reset - Users must conduct a reset when operating the desk for the first time. Simultaneously press **+** and **-** for 3 seconds. Continue pressing the buttons until both columns are in the lowest position. When finished with the reset, the control box will make a "beep" sound, and the buttons can be released.

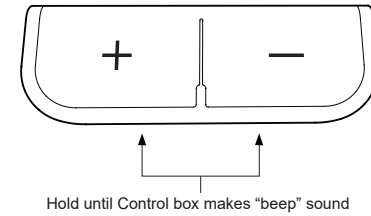

2. Adjusting the Height

Press **+** or **-** button until the desk reaches the preferred height.

