



## 5. Switching Metric and Imperial

- (1) Press memory buttons 1, 2 and 4 for 5 seconds.
- (2) The digital display will show "C-I". If no further instruction is input within 5 seconds, the system reverts to normal operation.

### How to choose a *metric* unit:

Press button 2, the digital display will show "C" to stand for centimeter.

### How to choose a *imperial* unit:

Press button 3, the digital display will show "I" to stand for inch.

## 6. Feature for Special Conditions- Setting the Upper and Lower Height Limit

### Setting the *upper* height limit:

- (1) Adjust the desk to the preferred upper height limit.
- (2) Press **+** and **-** buttons together for less than 3 seconds, holding **+** and release **-** button.  
Note: Some control boxes may not support setting the upper and lower height limit functionality.
- (3) Re-press **-** for more than 3 times at a slow pace.
- (4) A beeping sound will notify you that the process has been completed.

### Disable the *upper* height limit:

- (1) Set the desk to the upper height limit.
- (2) Repeat instructions #2~4 above to disable the upper limit setting.

### Setting the *lower* height limit:

- (1) Adjust the desk to the preferred lower height limit.
- (2) Press **+** and **-** buttons together for less than 3 seconds, holding **+** and release **-** button.  
Note: More than 3 seconds will direct to "Reset" mode.
- (3) Re-press **-** for more than 3 times at a slow pace.
- (4) A beeping sound will notify you that the process has been completed.

### Disable the *lower* height limit:

- (1) Move the desk to the lower height limit being set.
- (2) Repeat instructions #2~4 above to disable the upper limit setting.



# Memory Height Control

Visit our website for purchasing additional products, maintenance, warranty information, and to find the latest news from HOME Office Complete:

[www.homeofficecomplete.com](http://www.homeofficecomplete.com)

# Memory Height Control

Retrofittable Unit

USER MANUAL



Height Control Mount Screw (2)

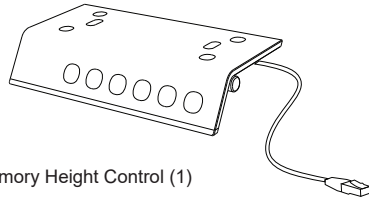

Memory Height Control (1)

Installation

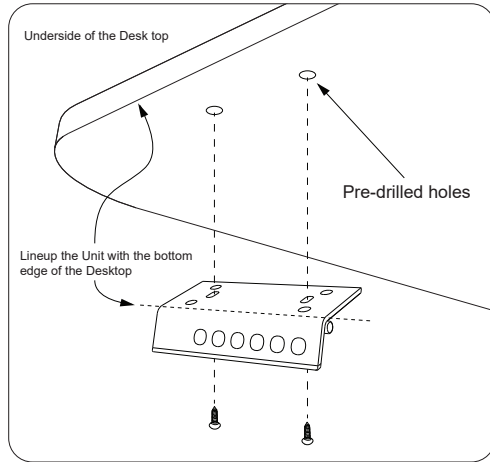

**STEP 1** Install the Memory Height Control unit into the pre-drilled holes located on the underside of the Desktop. Before tightening the screws, line up the Unit with the bottom edge of the Desktop.

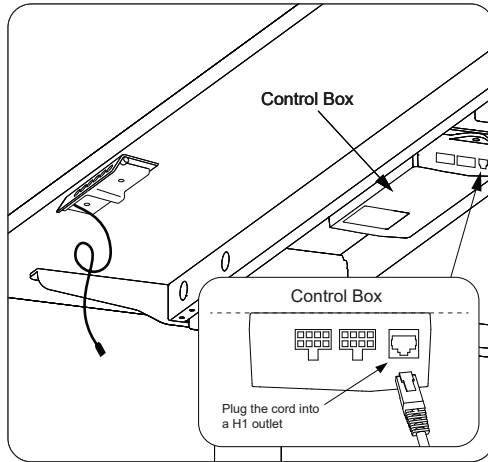

**STEP 2** After installing the Memory Height Control unit, connect it to the Control Box located on the underside of the Desktop between Desk construction beams. Plug the cord into the H1 outlet on the Control Box.

**WARNING:** To be installed on Desk Tops with a minimum thickness of 3/4"

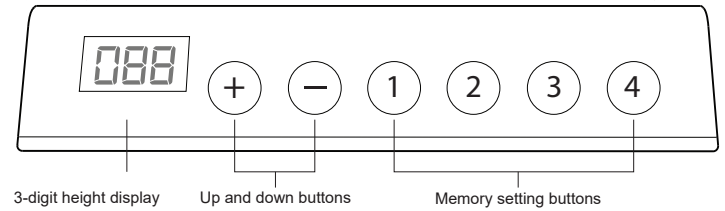

**1. Reset** - Users must conduct a reset when operating the desk for the first time. Simultaneously press **+** and **-** for 3 seconds. Continue pressing the buttons until both columns are in the lowest position. When finished with the reset, the control box will make a "beep" sound, and the buttons can be released. When finished with the reset, the display will show the starting height.

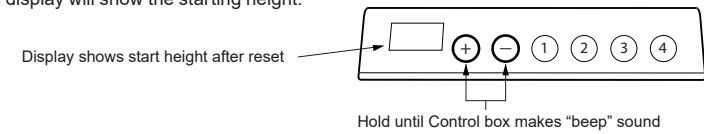

**2. Adjusting the Height**  
Press the **+** or **-** button until the desk reaches the preferred height.

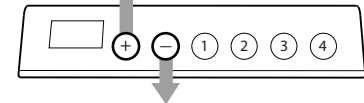

**3. Presetting the Desk Starting Height**

- (1) Press the **-** button until the desk reaches its lowest position and then release the **-** button. Press **-** button again and hold until display starts flashing.
- (2) Adjust the starting height number with the **+** or **-** button.
- (3) After 10 seconds, the display will stop flashing. This will confirm that you have completed setting the start height.

**4. Setting the Memorized Position** - Memory Height Control supports a maximum of 4 memory positions. To memorize a position, adjust the desk to the desired height. Press preferred memory button (1, 2, 3, 4), with either **+** or **-** for 2 seconds, once the display shows P1 or P2 or P3 or P4, the position is memorized.

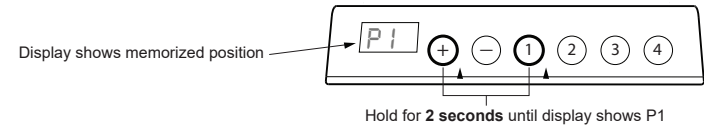

After successful setup press button 1, 2, 3 or 4 to move the desk to the memorized position.